

Item # 70

Date: 10/9/23

Date: October 4, 2023

Agenda Item: Nevada Field House Rental, Pass and User Fees

History:

With the Nevada Field House nearing completion, we are needing to establish user fees. We have conducted quite a bit of research in regards to fees for specific areas in the Field House, however, as program-based facility, we are very unique. We have searched online pass and user fee information from facilities around the area and throughout Iowa and outside the state, we also visited the RecPlex in West Des Moines.

Our goal has always been to provide all citizens the opportunity to utilize the Field House at an affordable cost. With our current pass and fee proposal, we feel as if we have found balance in both usability and affordability. It is important to note that each person (user) will be considered as an individual when purchasing a pass. Family dynamics and our software capabilities are major drivers in transitioning to individual passes for all of our recreational opportunities. Our RecDesk software will allow for the offering of these various passes without issue. Individuals will receive notification when their pass is about to expire.

Rental, Pass and User Fees:

Approved Fees in April 2023

Burke Turf: \$150.00/hour

Burke North ½: \$75.00/hour

Burke South ½: \$75.00/hour Add Batting Cages: \$20.00/hour

ALMACO Court: \$40.00/hour Add Game Set Up: \$20.00/hour

Mid-States Court: \$40.00/hour Add Game Set Up: \$20.00/hour

The Arena Multipurpose Area: \$30.00/hour

Cassabaum Family Indoor Play Area: \$125.00/1.5 hours

Burke Court (Availability Varies): \$40.00/hour Add Game Set Up: \$20.00/hour

Proposed Additional Fees and Alterations: (Please see attached information)

Field House Playground & Track Pass: FREE

Jr. Left Lane Legends Youth Pass (10 years old and under): \$80.00/year

Left Lane Legends Youth Pass (11-18 year olds): \$250.00/year

Adult Access Pass: \$120.00/year or \$12.00/month

Open Gym Punch Pass: \$5.00/day.

The Arena Multipurpose Area and Option of Partial Track: \$50.00/hour

Full Track Rental: Not Available for Rent other than special event

Burke South ½: \$75.00/hour Add Batting Cages: \$25.00/hour

FOB Replacement: \$25.00

Membership Card Replacement: \$5.00

Special Events: Regular Rental Rate(s) with addition of time, labor, and equipment fees

Options:

1. Adopt the proposed fee structure as part of the City of Nevada Fee Appendix.
2. Adopt the proposed fee structure with modifications.
3. Conduct more research and bring back additional information for consideration.

Recommendation:

Board and staff recommend that we adopt the fees as listed to the City's fee appendix with review within the first year of operation.

If you have any questions, please feel free to contact me at 382-4352 (office) or by email at nevadarecreation@gmail.com

Nevada Field House Proposed Pass Information and Fees

1 – Field House Playground & Track Pass: FREE

This pass is available for those that wish to walk/run on the track or play with their child in the indoor playground during open facility hours. Hours vary on time of year, typically the building will be open M-F from 8:00 a.m. – 5:00 p.m. We will encourage parents to come walk or play with their children in the indoor play space during times in which we are having scheduled parks and recreation programs such as youth basketball, volleyball, etc. These times will be “free” for those who have a Field House Playground & Track Pass.

2 – Left Lane Legends Youth Pass (11-18 year olds): \$250.00/year

This youth pass is for those that are interested in sports development and attending regular open gym times including after school open gym. Includes use of batting cages, turf area, courts, multi-purpose space, track, etc. during available open gym times. Reservations will be required for batting cage access (must have adult supervision). This pass can be purchased at anytime and good for 1 year from purchase date. For outside of normal facility hours, pass holder must be accompanied by an adult with an Adult Access Pass.

3 – Jr. Left Lane Legends Youth Pass (10 years old and under): \$80.00/year

This youth pass includes use of batting cages, turf area, courts, multi-purpose space, track, and indoor playground, during available open gym times including Cub Club. Reservations will be required for batting cage access (must have adult supervision). This pass can be purchased anytime and is good for 1 year from purchase date. Children with this pass must be accompanied by an adult in the facility, at all times.

4 – Adult Access Pass: \$120.00/year or \$12.00/month

This pass is for high school graduated adults 18 and over who wish to use the facility outside of traditional open hours, utilize sports surfaces for pick up play, and those adults accompanying their child(ren) outside of normal facility hours. Facility access from 5:00 a.m. – 11:00 p.m. daily. \$12.00/month fee or \$120.00/year. Reservations will be required for some amenities, for example, batting cages. Paying yearly fee includes building entry with a FOB, pin number or key card, those paying monthly will be given a pin number for building entry. Each FOB is assigned to an individual. Anyone found misusing a FOB is subject to having their pass revoked.

5 – Open Gym Punch Pass: \$5.00/day. The open gym punch pass can be used for access during open gym times. Does not include spaces in use by other groups or batting cages. Children 10 and under must be accompanied by a paying adult.

Batting Cages: Each Batting Cage can be reserved by anyone with an adult access pass for one hour with a maximum of 3 individuals utilizing the cage, including the adult supervisor. Participants must have a Youth Pass or Adult Access Pass. Those without a pass are required to pay a \$20.00 batting cage drop-in fee.

Those without a Facility Pass can rent a cage for \$25.00/cage/hour with a maximum of 3 individuals in each cage, including the renter. Teams using the batting cages must rent the entire south turf at \$100.00/hour. Youth Passes are not allowed during team rentals.

After School Open Gym

3:30-5:00 p.m. Monday - Thursday (Nevada School Days Only and scheduled early out days)

Fee: Left Lane Legends Youth Pass or \$5.00/time drop-in fee. Punch pass can be purchased on RecDesk Website.

This is a program at the Field House for student's 11 years old and above to come utilize the courts, north turf, social gathering area, etc. This gives our young community members a safe place to gather, play with friends, work on sport skills, do homework, make new friends, etc. This is considered an open gym time, the facility will be supervised, however all participants must follow all facility rules and understand expectations. There will be times when parks and recreation staff and/or outside entities provide special activities, however, this will primarily be open supervised play.

Cub Club

Cub Club is an indoor play time for little ones. Enjoy our indoor playground along with play time on the courts and/or turf at the Nevada Field House. Cub Club is a great time to meet new friends and just play. Join us Monday - Friday from 9:00 AM to 11:00 AM (with the exception of holidays and special events). This is a great opportunity for parents and grandparents to bring their little ones to an indoor playground. Cub Club Punch Pass can be purchased at any time on RecDesk. \$5.00/child/time or Jr. Legends Youth Pass. Adult supervisors and babies in carriers are free. Children must be accompanied by an adult at all times.

Additional Information

- Passes allowed on all days with the exception Thanksgiving, Christmas Eve and Christmas Day and special events.
- Individuals that utilize the facility must have a properly set up RecDesk account.
- Cage, court, turf and other areas available to reserve at current rental rates, when available.
- Anyone giving instructional lessons in the facility must complete the Nevada Park and Rec Program/Activity Information Form and follow all guidelines.
- Nevada Parks and Recreation reserves the right to revoke any and all passes due to misuse of pass or building entry system.
- There are additional fees for specific parks and recreation programs and activities.
- All passes are individual passes and may not be canceled or transferred to another person.
- Facility open gym availability will be announced on a monthly basis.
- Nevada Parks and Recreation reserves the right to modify or change facility availability at any time due to programming, rentals, or other circumstances beyond our control.



MidAmerican Energy RecPlex

Fees & Charges

Effective December 1, 2022

Page 1 of 2

ITEM - ACTIVITY	2022
*General Manager has authority to negotiate as required per market demand	
Ice Rental	
Ice Rental - In Season (October - March)	\$285.00/hr
Ice Rental - Off Season (April - September)	\$250.00/hr
Court Rental	
Full Court Rental - 1 BB/2 VB (Year Round, All day)	\$48.00/hr
Indoor Turf Rental	
Indoor Turf - Prime Time - Full Field (M-Th, 4p-9p/Fri, 4p-12a/Sa. 8a-12a/Sun. 8a-9p)	\$400.00/hr
Indoor Turf - Prime Time - 1/3 Field (M-F, 4p-9p/Sa. 8a-MidNight/Sun. 8a-9p)	\$160.00/hr
Indoor Turf - 2nd Tier - Full Field (M-Su, 6a-8a/Sun-Thurs, 9p-MidNight)	\$340.00/hr
Indoor Turf - 2nd Tier - 1/3 Field (M-Su, 6a-8a/Sun-Thurs, 9p-MidNight)	\$140.00/hr
Indoor Turf - 3rd Tier - Full Field (M-F, 8a-4p)	\$250.00/hr
Indoor Turf - 3rd Tier - 1/3 Field (M-F, 8a-4p)	\$110.00/hr
Indoor Turf - Off-Season - April 15th - November 15th	\$125.00/hr
Indoor Turf - Off-Season - 1/3 Field - April 15th - November 15th	\$60.00/hr
Outdoor Turf Rental	
Outdoor Field Rental - Full Field (Year Round, All day)	\$80.00/hr
Pickleball Courts	
Court Rental - Per Hour/Per Court (Red, White)	\$15.00/hr
Multipurpose/Batting Cage Area	
Warmup/Batting Cage Area - all cages up	\$100.00/hr
Warmup/Batting Cage Area - any or all cages down	\$125.00/hr
Batting Cages	
Per Tunnel	\$25.00/hr
Multipurpose Rooms	
Activities Room (Single room near Arena 2)	\$25.00/hr
Kum & Go Rooms (A, B, C) (Connecting rooms near fieldhouse) *per room	\$45.00/hr
Overlook Room (Overlooking 4th court on mezzanine)	\$35.00/hr
eSports Room	
Full room rental including all devices	\$150.00/hr



MidAmerican Energy RecPlex



Fees & Charges

Effective December 1, 2022

Page 2 of 2

ITEM - ACTIVITY	2022
Admission	
Admission Only Per Skater	\$7.00
Rental Skates	\$4.00
Drop-In Fees	
Drop-In Stick & Puck - per player/no charge for goalies	\$8.00
Drop-In Figure Skating - per skater	\$12.00
Drop-In Gym	\$5.00
Drop-In Pickleball	\$3.00
Drop-In Turf	\$5.00
Drop-In Esports - Per P/C Station	\$8.00/hr
Drop In Eposrts - Gaming Console	\$10.00/hr
Drop-In Esports - Virtual Reality Headset	\$25.00/hr
Drop-In Walking	\$3.00
Drop-In Toddler Time	\$1.00
Event Pricing	
Esports Room - (2 hours including party space, food for 11 people)	\$350.00
During Public Skate - (3 hours including admission, skates, food for 11 people)	\$250.00
*Sporting surface not included (ie: ice, court or field charge additional)	
Special Event Rental	
Greg Abel Arena, Wells Fargo Courts, Hy-Vee Fieldhouse Indoor Field	
- Full service event including set up & clean up	\$8,000/day
- Full service event including limited set up & clean up	\$2,000/day
- Limited rental with minimal set up or clean up	\$1,000/day
- Limited rental with no set up or clean up	\$450/day
Patty & Jim Cownie Family Arena	
- Full service event including set up & clean up	\$4,000/day
- Full service event including limited set up & clean up	\$1,500/day
- Limited rental with minimal set up or clean up	\$1,000/day
- Limited rental with no set up or clean up	\$450/day
Special Event Rental Equipment	
Pricing to be determined by current market rates	

S A L I N A



FIELDHOUSE

RENTAL RATES

Events: Whole Facility (2 Gyms, 6 Courts, Lobby) Rental Rates	Spaces Available	Whole Facility	Half Facility
Sat./Sun: All Courts (8am - 8pm)	6	\$3,100.00	\$1,550.00
Single Day All Courts (8am - 8pm)	6	\$1,700.00	\$850.00
Partial Single Day All Courts (8am - 4pm)	6	\$1,300.00	\$650.00

Hourly Court Rental Rates	Spaces Available	Events	Practice
Full Court Basketball/Volleyball/Futsal	6	\$40.00	\$30.00
Half Court Basketball/Volleyball/Futsal	12	\$30.00	\$20.00

Hourly Turf Rental Rates	Spaces Available	M-F 5:30pm & Weekends	Weekdays Before 5:30am
Turf: 1/3 Field - 100' X 70'	3	\$45.00	\$35.00
Turf: Middle Section - 60' X 70'	3	\$30.00	\$20.00
Turf: Tunnel - 20' X 70'	6	\$15.00	\$15.00
Pitching Machine/Hour	6	\$10.00	\$10.00

Additional Event Rate Descriptions	Time	Rate
Non-Refundable Deposit for Single Day/Full Weekend	Per Event	\$250.00
Vendor/Food Truck Fee (Must have City Permits)	Per Vendor/Per Event	\$25.00
Temporary Advertising/Banner Fee	Per Event	\$25.00
Pre-Event/On-Site/Post Event Hourly Staff & Custodial	Per Hour/Staff	\$12.00
Concessions/Day	Per Day	\$75.00
Concessions/Hour	Per Hour	\$25.00
Special Requests: Equipment, Staff, Miscellaneous Fees	Direct Time	Direct Cost

Separate Lobby Rental Rates	Time	Rate
Full Lobby (8am-8pm)	Per Day	\$200.00
Full Lobby/Hour	Per Hour	\$50.00
Half Lobby/Hour	Per Hour	\$25.00

Annual Program Rates	Time	Rate
B-Day Party Packages (Half Lobby+1 Court/Turf Space+Staff)	2 hours	\$125.00
Youth & Adult Drop-In: Specific Dates/Times (See Brochure)	Per Day	\$3.00
Toddler Time: Specific Dates/Times (See Activity Brochure)	Per Day	\$2.00

Revised 9/10/20

*Rates subject to change per Salina Fieldhouse Advisory Board/Recreation Superintendent discretion.

*Rates include set-up and tear-down time.



Browse Events Memberships Passes

Diamond Family Membership

\$420.56
Annually

This Full Membership offers access to...

Purchase View Details

Diamond Individual Members...

\$257.01
Annually

This Full Membership offers access to...

Purchase View Details

Diamond Family Membership...

\$17.88 \$93.46
Monthly Join Fee

This Full Membership offers access to...

Purchase View Details



Diamond In The Rough
DiamondInTheRoughWC.com

Create Account

Login

< Event

Day Visit

Visits | 1h duration

Purchase

\$20.00

Address

Staff

Diamond In The
Rough
203 Commerce Dr
Webster City, IA
50595



Staff Member

Restrictions

Gender **Coed**

Details

Daily Visit Fee \$20. This fee is valid for the whole day.

No Charge for Member Daily Visits



[Browse Events](#) [Memberships](#) [Passes](#)

Multi-Visit Credit Pass 5 Pack (Punch Pass)

5 Credits · \$50.00

180 day expiration from first use

Purchase

[View Details](#)



Character is built,
goals are achieved,
dreams are made.

INSIDE THE HOUSE

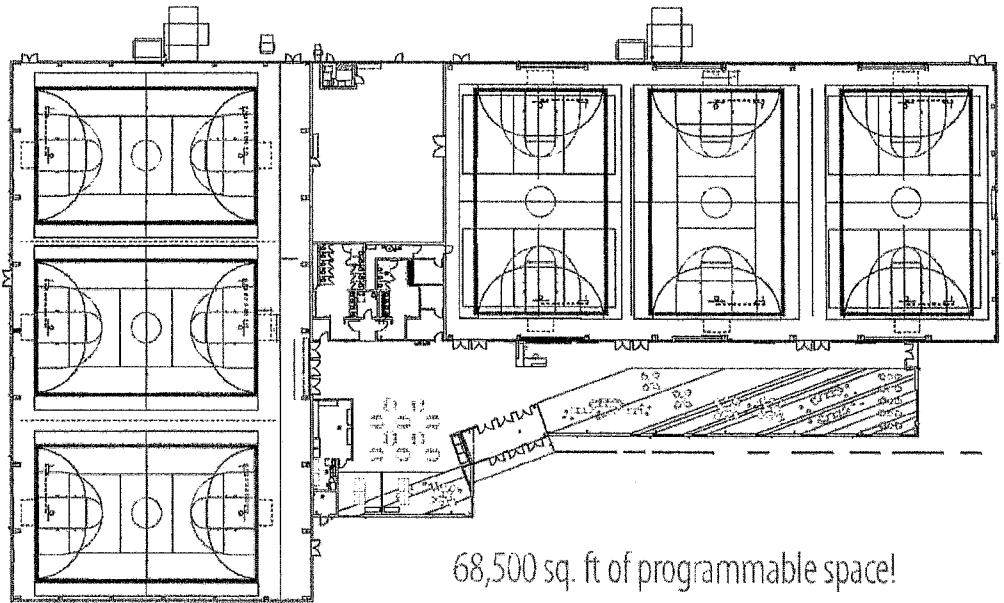

The Salina Fieldhouse features more than 68,500 square feet of programmable space to encompass a wide variety of sports and events.

Looking for the ultimate venue?

BRING IT TO THE HOUSE!



Salina
Parks & Recreation
A Department of the City of Salina
300 W. Ash St., Salina, KS 67401
(785) 833-2260
fieldhouse@salina.org
www.SalinaFieldhouse.com

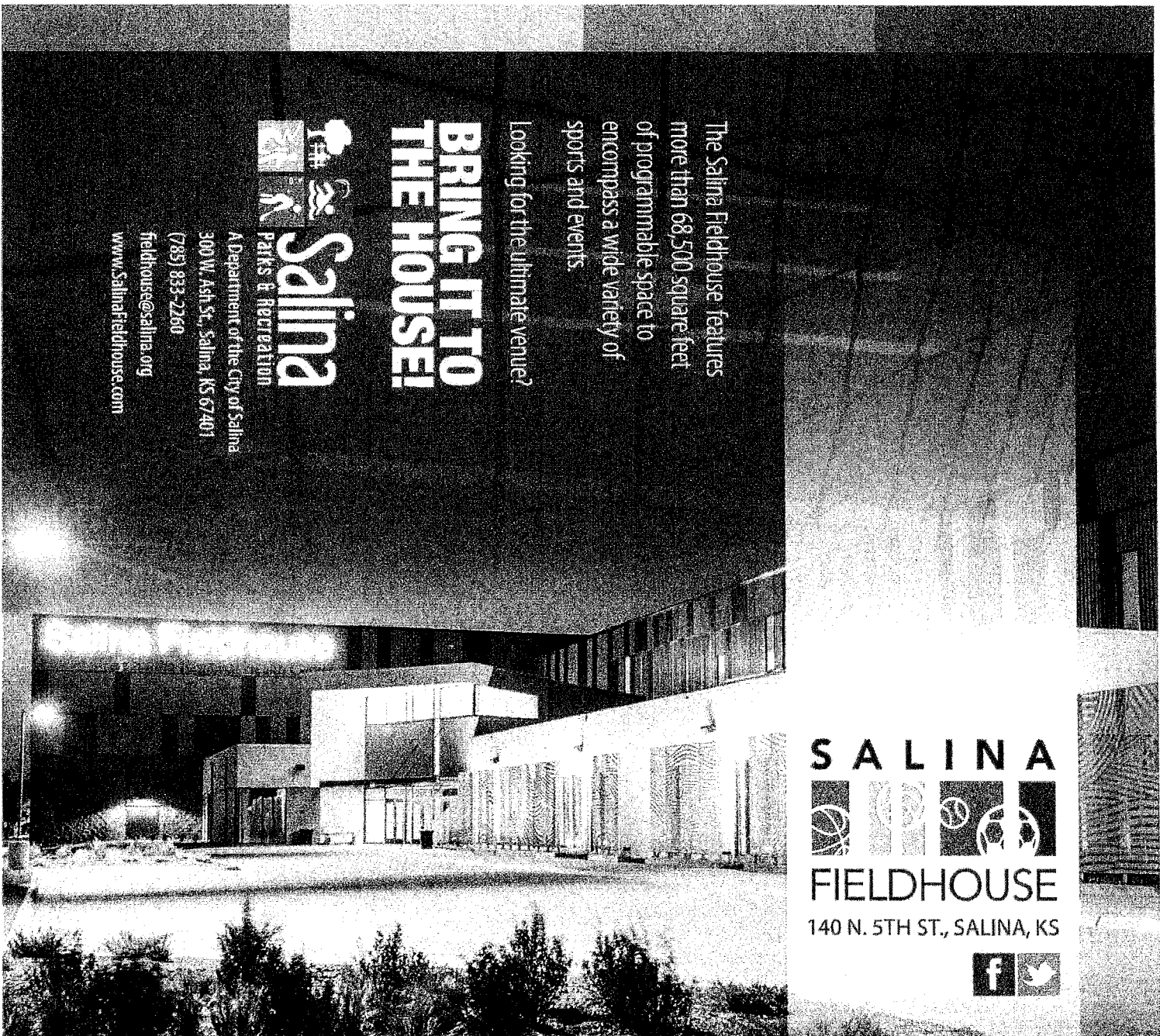

SALINA



FIELDHOUSE

140 N. 5TH ST., SALINA, KS



basketball
volleyball
soccer/futsal
football
kickball
baseball
softball
lacrosse
dodgeball
cheer & dance
golf & more!

EVERYONE... BRING IT TO THE HOUSE



Camps and Clinics

The Salina Fieldhouse features more than 68,500 square feet of programmable space to encompass a wide variety of sports and events.

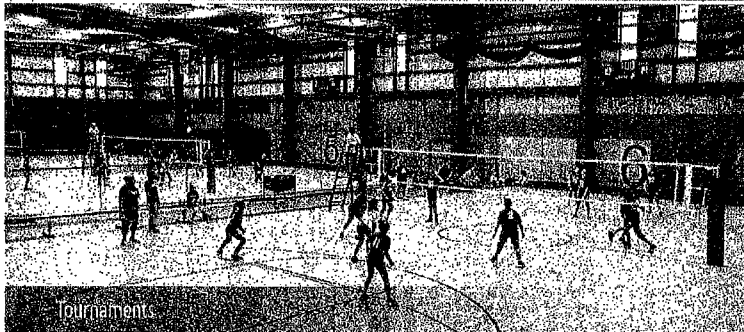

Tournaments

Host an Event

The Salina Fieldhouse serves as host to league play, tournaments, camps, practices, camps, clinics, and various events. Our state-of-the-art hardwood and synthetic courts can host virtually any indoor sport, league and



Multi-Surface

Facility Amenities

You're going to love our spacious foyer, comfortable lobby, and team-gathering areas!

- Hardwood basketball courts (3)
- Synthetic basketball courts (3)
- Volleyball courts (8)
- Regulation-size indoor soccer field or small-sided games (3)
- Batting and pitching tunnels
- Bleacher seating
- Concessions
- Meeting space
- Plenty of parking



Meeting Areas and Concession Opportunities

Contact Us

If you are interested in hosting an event at the Salina Fieldhouse:

Travis Scheele, Recreation Superintendent
Salina Parks & Recreation
785-833-2260
fieldhouse@salina.org
www.SalinaFieldhouse.com

For information about accommodations, dining, things to see and do, and event support:

Tiffany Benien, Sports & Special Events Manager
Visit Salina/Salina Area Chamber of Commerce
785-827-9301
tbenien@salinakansas.org
www.VisitSalinaKS.org